

Sanitary drain – single-part SSK-E-S – vertical

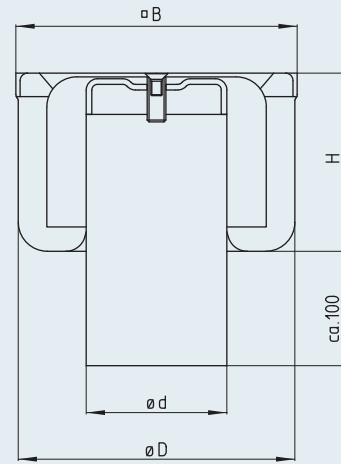

B = W
HV = HA

Model	DN	Ø d [mm]	Ø W [mm]	Ø W [mm]	Ø D [mm]	H [mm]	Silt box volume [l]	Flow rate [l/s]
SSK-050-E-S	50	50	150	-	148	95	-	> 1.0
SSK-070-E-S	70	75	150	-	148	95	-	> 1.5
SSK-100-E-S	100	110	197	-	183	108	-	> 2.8

Cover variants

■ Slit plate cover

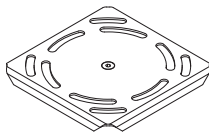

■ Plate cover 10 mm

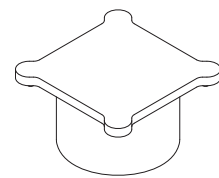

■ Perforated plate cover 8 x 8 mm

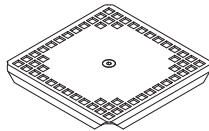

■ Perforated plate cover ø 8 mm, not illustrated

Inlet rim

■ square

Grade

■ 1.4301 (AISI 304) ■ 1.4571 (AISI 316 Ti)¹⁾

Description for use in tenders

Sanitary drain, single-part, Model SSK, according to EN 1253. Square inlet rim seamlessly formed to fit the housing. To achieve a high self-cleansing effect, the bottom of the housing has large and deep-drawn inside radius. With screw-attached plate cover and air trap, stainless steel. Vertical outlet. Surface grain blasted.

Nominal width:	• DN 50	• DN 70	• DN 100
Grade:	• 1.4301 [AISI 304]	• 1.4571 [AISI 316 Ti] ¹⁾	
Cover:	• Slit plate cover screwed	• Perforated plate cover 8 x 8 mm screwed	• Perforated plate cover ø 8 mm screwed
			• Plate 10 mm with air trap welded below

¹⁾ If grade 1.4571 is used (AISI 316Ti) some components may be made of grade 1.4404 (AISI 316) for construction reasons

Sanitary drain – two-part SSK-E-S-HV – vertical

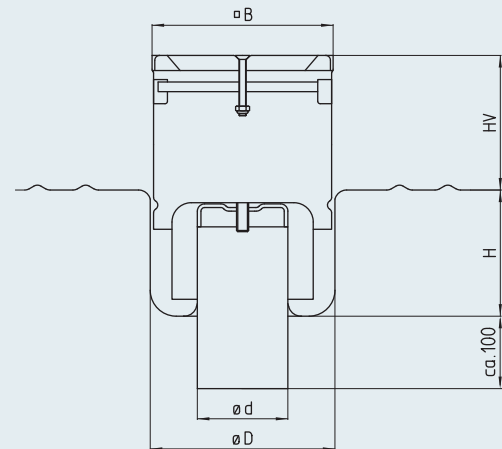

Model	DN	$\varnothing d$ [mm]	$\square B$ [mm]	$\varnothing B$ [mm]	$\varnothing D$ [mm]	H [mm]	HV [mm]	Silt box volume [l]	Flow rate [l/s]
SSK-050-E-S-HV	50	50	150	-	153	106	60-110	-	> 1.0
SSK-070-E-S-HV	70	75	150	-	153	106	60-110	-	> 1.5
SSK-100-E-S-HV	100	110	197	-	190	119	60-110	-	> 2.8

Cover variants

- Slit plate cover

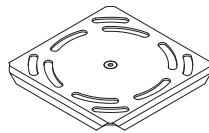

- Plate cover 10 mm, L15

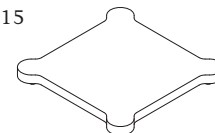

- Perforated plate cover 8 x 8 mm

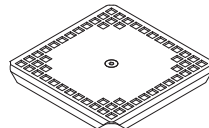

- Perforated plate cover $\varnothing 8$ mm, not illustrated

Inlet rim

- square

Grade

- 1.4301 (AISI 304) ■ 1.4571 (AISI 316 Ti)¹⁾

Description for use in tenders

Adjustable-height sanitary drain, two-part, Model SSK, according to EN 1253. Upper-part can be infinitely height adjusted and twisted, without sealing ring. Square inlet rim has been seamlessly shaped to fit the housing. To achieve a high self-cleansing effect, the bottom of the housing has large and deep-drawn inside radius. With stainless steel screwed plate cover and air trap. Vertical outlet. Surface grain blasted/pickled.

Nominal width:	• DN 50	• DN 70	• DN 100
Grade:	• 1.4301 [AISI 304]	• 1.4571 [AISI 316 Ti] ¹⁾	
Cover:	• Slit plate cover screwed	• Perforated plate cover 8 x 8 mm screwed	• Perforated plate cover $\varnothing 8$ mm with screwed
			• Plate cover 10 mm with air trap welded below
Sealing ring:	• with sealing ring (i.e. without secondary drainage)		

¹⁾ If grade 1.4571 is used (AISI 316Ti) some components may be made of grade 1.4404 (AISI 316) for construction reasons